

Chemical Seal Gauge With Bolted Seal



Model 14B

Application:

These seals are combined for use with pressure gauges or transmitters, and are intended for use in the Chemical Industry

Nominal Dial Sizes:

63mm, 100mm 160mm, 200mm & 250mm

Accuracy:

1.6%

Pressure Rating:

Up to 600 bar maximum

This instrument can be fitted with a variety of flanges or threads, different applications require different solutions, please contact us for advice

Specifications

Case & Bezel:

304 St. St with Bayonet locking bezel
Weatherproof construction

Connection & Element:

AISI 316 Stainless Steel

Movement:

Stainless Steel

Dial:

White Aluminium with black markings

Pointer:

Black Oxidised Aluminium

Window:

Glass

Optional Specifications

PTFE lining with PTFE protected diaphragm

(pressure only) for vacuum

diaphragm is PFA coated

Perspex window

Liquid filling

Customer logo

Male threads

Electrical contacts

Remote type with St St capillary, flush

panel or surface mounting

Chemical Seal Gauge With Bolted Seal

Type identification assistant

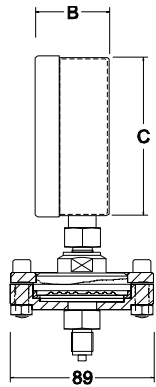

Model: 14BT10

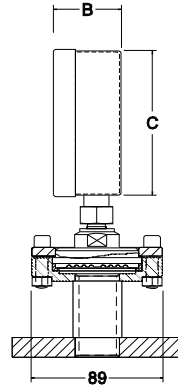
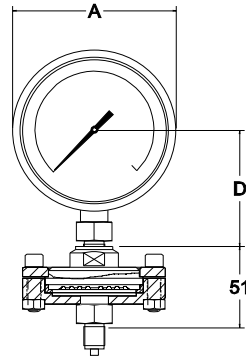

Model: 14BF10

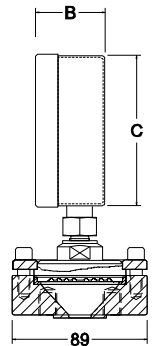
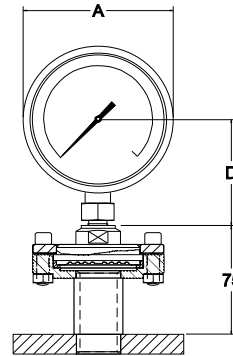

Model: 14BF20

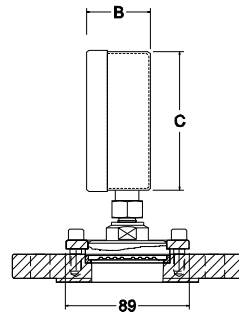
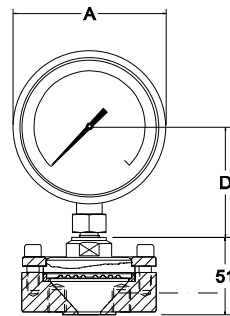

Model: 14BF30

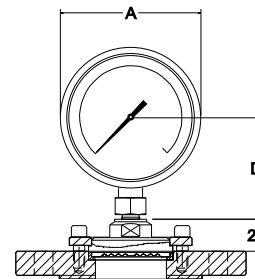

Ordering information

State: Pressure gauge model / Nominal size / Scale range / Size of connection / Optional extras required

Example

14BF10/100mm/0-10bar/1"ANSI 150 flange
100mm (4")
Stainless Steel Case / Stainless Steel wetted parts, 0-10bar, with 1" ANSI 150 flange.

Dial Size	A	B	C	D
100mm	112	48.5	99	72
160mm	162	48.5	148	90