

U Syphons

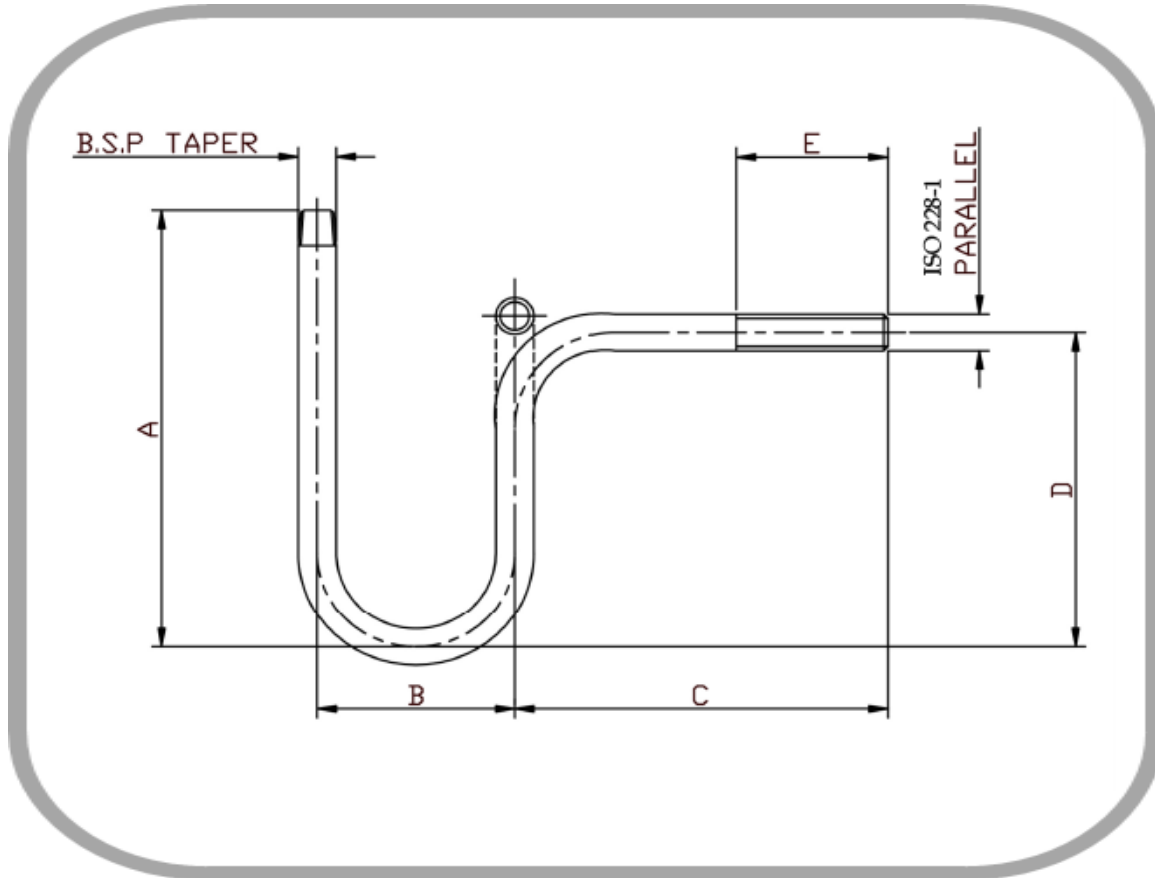

- *Pressure rating up to 50 BAR (750 PSI)
- *Male threads are BSPT (Taper) to ISO 7-1 and BSPP (Parallel) to ISO 228-1
- *316L stainless steel
- *Manufactured from pipe
- *Sizes 1/4" to 1/2"

Size	A	B	C	D	E	Kg/100
1/4	154.5	68.5	86.0	132.0	38.5	25.0
3/8	163.0	73.0	94.5	136.5	40.0	36.2
1/2	210.5	91.5	124.0	174.5	55.0	69.2